

### ADRIA TWIN PLUS 540 SP

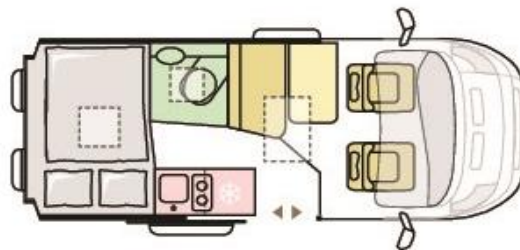
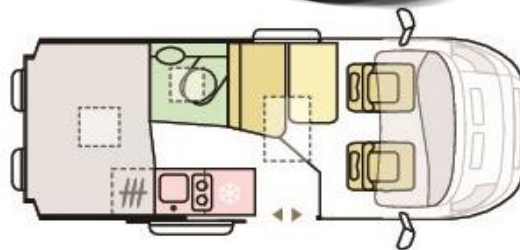

### TECHNICAL DATA

CHASSIS	
Emissions rating	Euro 6D
Citroen 6 2.2 140 Hp 35 L	X
DIMENSIONS AND WEIGHTS	
Body length (mm)	5413
Total width (mm)	2050
Total height (mm)	2580
Internal height (mm)	1900
Mass in running order (Kg)	2650
Maximum authorized weight (Kg)	3500
Maximum towing weight (Kg)	2000
Wheel base (mm)	4035
Nr. Of homologated seats incl. Driver's seat	4
CHASSIS EQUIPMENT	
Spare wheel FIAT	X
ABS	X
Colored front shock bumper white	X
Front fog lights	X
Rear fog lights	X
Double electric door mirror with demist. Function	X
Led daytime running lights Fiat	X
DRL halogen daytime running lights	X
Reinforced camping car tires	X
Front drive	X

Ad Blue tank (Lt.)		20
Fuel tank (Lt.)		90
Manual transmission		X
Traction +system with HDC		X
ESP System		X
Cruise control		X
<b>CABIN EQUIPMENT</b>		
Manual air condition Fiat		X
Electric cabin windows (left, right)		X
Cabin seats adjustable in height and deepness		X
Cabin seats upholstered in living room textile		X
Cabin seats covering in living room textile		X
Front seats Captain chair with double armrest upholstered in living room textile		X
Swiveling cabin seats		X
Trip computer		X
Driver airbag		X
Co-driver airbag		X
Darker cabin windows		X
Cabin oscuration with barrier curtain		X
<b>BODY</b>		
Adria windows - darker		X
Roof light 700 X 500 in living space		X
Roof light 400 X 400 in bedroom		X
Roof light 280x280 in bathroom		X
Gas bottle compartment, integrated 2 x 10 Kg		X
Outside electrical entrance step		X
Third break light		X
<b>INTERIOR EQUIPMENT</b>		
Number of berths		2
Sleeping area, rear berth (mm)	1960x1340-1160	
ISOFIX installation for child safety seat		X
Double floor in sitting area		X
Bed with slatted frame and special foam		X
Dinette cushions - special foam 120 mm		X
<b>KITCHEN EQUIPMENT</b>		
Monoblock Can		X
Refrigerator		84
<b>BETHROOM EQUIPMENT</b>		
Wc chemical, turnable, passive ventilated		X
Shower tray		X
Shower faucet (sink + shower)		X
<b>WATER INSTALLATION</b>		
Fresh water tank with external inlet (Lt)		100
Waste water tank (Lt.)		70
Submersible water pump		X
<b>ELECTRIC INSTALLATION</b>		
Power socket 230 V		X
Sockets 12 V		X
Sockets USB		X
Main security switch for 230 V		X
Main security switch 12 V		X
Ceiling led lights		X
Spot led lights		X
Ambient led lights		X
Electro block		X
Panel control		X
<b>HEATING / AIR CONDITIONING</b>		
Heater gas Truma		X
Boiler Truma		X
<b>GAS INSTALLATION</b>		
Gas regulator Truma Mono Control CS		X

## AUDIO / VIDEO

Breaklight rearview camera with monitor in rearview mirror	X
Rear parking sensors	X

### Booking Camper Srl

Via A. Mazzi, 38

24018 - Villa d'Almè (BG)

Telefono: 035296386

[www.bookingcamper.com](http://www.bookingcamper.com)

[info@bookingcamper.com](mailto:info@bookingcamper.com)